



SEPA ENVIRONMENTAL CHECKLIST SUBMITTAL SUPPLEMENTAL

Form # PLN ENR 003-SS1-A
Revised: 8/12/14

Yakima County Public Services
128 North Second Street · Fourth Floor Courthouse · Yakima, Washington 98901
(509) 574-2300 · 1-800 572-7354 · FAX (509) 574-2301 · www.co.yakima.wa.us

WAC 197-11-960 Environmental checklist.

Purpose of checklist:

The State Environmental Policy Act (SEPA), chapter 43.21C RCW, requires all governmental agencies to consider the environmental impacts of a proposal before making decisions. An environmental impact statement (EIS) must be prepared for all proposals with probable significant adverse impacts on the quality of the environment. The purpose of this checklist is to provide information to help you and the agency identify impacts from your proposal (and to reduce or avoid impacts from the proposal, if it can be done) and to help the agency decide whether an EIS is required.

Instructions for applicants:

This environmental checklist asks you to describe some basic information about your proposal. Governmental agencies use this checklist to determine whether the environmental impacts of your proposal are significant, requiring preparation of an EIS. Answer the questions briefly, with the most precise information known, or give the best description you can.

You must answer each question accurately and carefully, to the best of your knowledge. In most cases, you should be able to answer the questions from your own observations or project plans without the need to hire experts. If you really do not know the answer, or if a question does not apply to your proposal, write "do not know" or "does not apply." Complete answers to the questions now may avoid unnecessary delays later.

Some questions ask about governmental regulations, such as zoning, shoreline, and landmark designations. Answer these questions if you can. If you have problems, the governmental agencies can assist you.

The checklist questions apply to all parts of your proposal, even if you plan to do them over a period of time or on different parcels of land. Attach any additional information that will help describe your proposal or its environmental effects. The agency to which you submit this checklist may ask you to explain your answers or provide additional information reasonably related to determining if there may be significant adverse impact.

Use of checklist for nonproject proposals:

For nonproject proposals complete this checklist and the supplemental sheet for nonproject actions (Part D). The lead agency may exclude any question for the environmental elements (Part B) which they determine do not contribute meaningfully to the analysis of the proposal.

For nonproject actions, the references in the checklist to the words "project," "applicant," and "property or site" should be read as "proposal," "proposer," and "affected geographic area," respectively.

(For Staff Use Only)

DATE: _____

REVIEWED BY: _____

PROJECT #: _____

CASE #: _____

RELATED FILES: _____

A. BACKGROUND

1. Name of proposed project, if applicable:

Not applicable

2. Name of applicant: Hordan Planning Services

3. Address and phone number of applicant and contact person:

410 North 2nd Street, Yakima, WA 98901 – (509) 249-1919 – Bill Hordan

4. Date checklist prepared:

November 27, 2018

5. Agency requesting checklist:

Yakima County Planning Department.

6. Proposed timing or schedule (including phasing, if applicable):

The project is scheduled to occur during the fall and winter of 2018/2019.

7. Do you have any plans for future additions, expansion, or further activity related to or connected with this proposal? If yes, explain.

Not at this time, however the property is part of a larger cemetery that is likely to expand into this area over time.

8. List any environmental information you know about that has been prepared, or will be prepared, directly related to this proposal.

None known.

9. Do you know whether applications are pending for governmental approvals of other proposals directly affecting the property covered by your proposal? If yes, explain.

No other proposal directly affecting this project are known to exist.

10. List any government approvals or permits that will be needed for your proposal, if known.

Yakima County Grading and Excavating Permit and air quality permit from YVRCCA.

11. Give brief, complete description of your proposal, including the proposed uses and the size of the project and site. There are several questions later in this checklist that ask you to describe certain aspects of your proposal. You do not need to repeat those answers on this page. (Lead agencies may modify this form to include additional specific information on project description.)

The proposal is to level and fill a vacant portion of a 10.75 acre parcel at Terrace Heights Memorial Park. An approximate 50,000 square foot area (140' x 350') of the 10.75 acres will be filled and levelled with approximately 2,500 cubic yards of imported fill dirt and top soil to match the surrounding topography. Once completed, the project area will be planted in grass.

12. Location of the proposal. Give sufficient information for a person to understand the precise location of your proposed project, including a street address, if any, and section, township, and range, if known. If a proposal would occur over a range of area, provide the range or boundaries of the site(s). Provide a legal description, site plan, vicinity map, and topographic map, if reasonably available. While you should submit any plans required by the agency, you are not required to duplicate maps or detailed plans submitted with any permit applications related to this checklist.

The address of the property is 3001 Terrace Heights Drive, Yakima, Washington 98901. The Assessor's Parcel Number is 191316-34004.

B. ENVIRONMENTAL ELEMENTS

1. Earth

a. General description of the site (circle one): Flat, rolling, hilly, steep slopes, mountainous, other.....

b. What is the steepest slope on the site (approximate percent slope)?

1 to 2 percent

c. What general types of soils are found on the site (for example, clay, sand, gravel, peat, muck)? If you know the classification of agricultural soils, specify them and note any agricultural land of long-term commercial significance and whether the proposal results in removing any of these soils.

According to the Soil Survey of Yakima County Area Washington, the soil found at the site is Weirman fine sandy loam. It is not classified as prime farmland. None of the soil will be removed from the property.

d. Are there surface indications or history of unstable soils in the immediate vicinity? If so, describe.

No.

e. Describe the purpose, type, total area, and approximate quantities and total affected area of any filling, excavation, and grading proposed. Indicate source of fill.

The 2,500 cubic yards of fill and topsoil will be coming from another construction project located at 1615 West Ahtanum Road in Union Gap, WA.

f. Could erosion occur as a result of clearing, construction, or use? If so, generally describe.

Some minor erosion could occur during site preparation from construction activities. Erosion would be expected to be in the form of blowing dust.

g. About what percent of the site will be covered with impervious surfaces after project construction (for example, asphalt or buildings)?

No impervious surfaces are proposed over the level and fill project area. The level and fill area will be planted in grass.

h. Proposed measures to reduce or control erosion, or other impacts to the earth, if any:

A water truck will be used to control blowing dust. If water erosion occurs, silt fencing will be used to prevent water-related erosion.

2. Air

a. What types of emissions to the air would result from the proposal during construction, operation, and maintenance when the project is completed? If any, generally describe and give approximate quantities if known.

Minor dust from levelling and filling activities could occur. Quantities are not known but should be minimal.

b. Are there any offsite sources of emissions or odor that may affect your proposal? If so, generally describe.

No.

c. Proposed measures to reduce or control emissions or other impacts to air, if any:

A water truck will be used to reduce and control air emissions and other impacts to the air.

3. Water

a. Surface:

1) Is there any surface water body on or in the immediate vicinity of the site (including year-round and seasonal streams, saltwater, lakes, ponds, wetlands)? If yes, describe type and provide names. If appropriate, state what stream or river it flows into.

The Moxee Canal lies approximately 300-350 feet north/northeast of the site.

2) Will the project require any work over, in, or adjacent to (within 200 feet) the described waters? If yes, please describe and attach available plans.

No work will occur within 200 feet of the Moxee Canal.

3) Estimate the amount of fill and dredge material that would be placed in or removed from surface water or wetlands and indicate the area of the site that would be affected. Indicate the source of fill material.

Not applicable.

4) Will the proposal require surface water withdrawals or diversions? Give general description, purpose, and approximate quantities if known.

No.

5) Does the proposal lie within a 100-year flood plain? If so, note location on the site plan.

No.

6) Does the proposal involve any discharges of waste materials to surface waters? If so, describe the type of waste and anticipated volume of discharge.

No.

b. Ground:

1) Will groundwater be withdrawn from a well for drinking water or other purposes? If so, give a general description of the well, proposed uses and approximate quantities withdrawn from the well? Will water be discharged to groundwater? Give general description, purpose, and approximate quantities if known.

No groundwater will be withdrawn.

2) Describe waste material that will be discharged into the ground from septic tanks or other sources, if any (for example: Domestic sewage; industrial, containing the following chemicals...; agricultural; etc.). Describe the general size of the system, the number of such systems, the number of houses to be served (if applicable), or the number of animals or humans the system(s) are expected to serve.

No waste material will be discharged into the ground by this project.

c. Water runoff (including storm water):

1) Describe the source of runoff (including storm water) and method of collection and disposal, if any (include quantities, if known). Where will this water flow? Will this water flow into other waters? If so, describe.

Storm water will percolate and evaporate from the project site as it has historically done.

2) Could waste materials enter ground or surface waters? If so, generally describe.

No.

3) Does the proposal alter or otherwise affect drainage patterns in the vicinity of the site? If so, describe.

The property is generally flat, and is proposed to remain flat, no drainage patterns in the vicinity will be affected.

d. Proposed measures to reduce or control surface, ground, runoff water, and drainage pattern impacts, if any:

Silt fencing will be used if determined necessary during the levelling and filling of the property.

4. Plants

a. Check the types of vegetation found on the site:

- Deciduous tree: Alder, maple, aspen, other
- Evergreen tree: Fir, cedar, pine, other
- Shrubs
- Grass
- Pasture
- Crop or grain
- Orchards, vineyards or other permanent crops.
- Wet soil plants: Cattail, buttercup, bullrush, skunk cabbage, other
- Water plants: Water lily, eelgrass, milfoil, other

XX Other types of vegetation – The project site is currently a weedy lot.

b. What kind and amount of vegetation will be removed or altered?

All the weeds will be removed from the levelling and filling area.

c. List threatened and endangered species known to be on or near the site.

None known.

d. Proposed landscaping, use of native plants, or other measures to preserve or enhance vegetation on the site, if any:

The site will be replanted with grass similar to that in the surrounding cemetery.

e. List all noxious weeds and invasive species known to be on or near the site.

No noxious weeds are known to be on or near the site.

5. Animals

a. List any birds and other animals which have been observed on or near the site or are known to be on or near the site. Examples include:

Birds: Hawk, heron, eagle, songbirds, other: waterfowl

Mammals: Deer, bear, elk, beaver, other:

Fish: Bass, salmon, trout, herring, shellfish, other:

b. List any threatened and endangered species known to be on or near the site.

None known.

c. Is the site part of a migration route? If so, explain.

No.

d. Proposed measures to preserve or enhance wildlife, if any:

None proposed.

e. List any invasive animal species known to be on or near the site.

No invasive animal species are known to be on or near the site.

6. Energy and natural resources

a. What kinds of energy (electric, natural gas, oil, wood stove, solar) will be used to meet the completed project's energy needs? Describe whether it will be used for heating, manufacturing, etc.

No energy is needed for this completed project.

b. Would your project affect the potential use of solar energy by adjacent properties? If so, generally describe.

No.

c. What kinds of energy conservation features are included in the plans of this proposal? List other proposed measures to reduce or control energy impacts, if any:

Not applicable, no energy is needed for the completed project.

7. Environmental health

a. Are there any environmental health hazards, including exposure to toxic chemicals, risk of fire and explosion, spill, or hazardous waste that could occur as a result of this proposal? If so, describe.

No environmental health hazards or toxic chemicals, risk of fire and explosion, spill or hazardous waste are associated with this project.

1) Describe any known or possible contamination at the site from present or past uses.

No contamination is known to be present at the site from present or past uses.

2) Describe existing hazardous chemicals/conditions that might affect project development and design. This includes underground hazardous liquid and gas transmission pipelines located within the project area and in the vicinity.

There are no existing chemicals/conditions that affect this project.

3) Describe any toxic or hazardous chemicals that might be stored, used, or produced during the project's development or construction, or at any time during the operating life of the project.

No toxic or hazardous chemicals are associated with this project.

4) Describe special emergency services that might be required.

No special emergency services are required for this project.

5) Proposed measures to reduce or control environmental health hazards, if any:

None needed, none proposed.

b. Noise

1) What types of noise exist in the area which may affect your project (for example: traffic, equipment, operation, other)?

No noise in the area will affect this proposal.

2) What types and levels of noise would be created by or associated with the project on a short-term or a long-term basis (for example: traffic, construction, operation, other)? Indicate what hours noise would come from the site.

Short-term noise will consist of activities associated with the levelling and filling of the property such as the use of a dozer blade and dump trucks. The hours would normally be from about 6:30 am to 5:00 pm, until the project is completed. No long-term noise is expected.

3) Proposed measures to reduce or control noise impacts, if any:

Compliance with the County Noise Ordinance, as it applies to this project.

8. Land and shoreline use

a. What is the current use of the site and adjacent properties? Will the proposal affect current land uses on nearby or adjacent properties? If so, describe.

The project site is a small portion of a larger 10.75 acre property that contains a cemetery, office, miscellaneous outbuildings and other associated accessory land uses. The adjacent property to the west is vacant and owned by Terrace Heights Memorial Park. Property to the north and east are also owned by Terrace Heights Memorial Park and are a cemetery. Properties to the south consist of local businesses (a television station and chapel). The proposal will not affect current land uses on nearby adjacent properties.

b. Has the project site been used as working farmlands or working forest lands? If so, describe. How much agricultural or forest land of long-term commercial significance will be converted to other uses as a result of the proposal, if any? If resource lands have not been designated, how many acres in farmland or forest land tax status will be converted to nonfarm or non-forest use?

Not applicable, the site has not been used as working farmlands or working forest lands.

1) Will the proposal affect or be affected by surrounding working farm or forest land normal business operations, such as oversize equipment access, the application of pesticides, tilling, and harvesting? If so, how:

No, the site lies within the community of Terrace Heights, Washington, which is within the Yakima Urban Area.

c. Describe any structures on the site.

The project site is vacant. The balance of the property contains an office, storage sheds, maintenance shop and crematorium.

d. Will any structures be demolished? If so, what?

No structures will be demolished.

e. What is the current zoning classification of the site?

Single-family Residential.

f. What is the current comprehensive plan designation of the site?

Urban Public

g. If applicable, what is the current shoreline master program designation of the site?

Not applicable.

h. Has any part of the site been classified critical area by the city or county? If so, specify.

No portion of the property is classified as a critical area by Yakima County.

i. Approximately how many people would reside or work in the completed project?

The project will not create any permanent jobs.

j. Approximately how many people would the completed project displace?

No people will be displaced by the completed project.

k. Proposed measures to avoid or reduce displacement impacts, if any:

None needed, none proposed

l. Proposed measures to ensure the proposal is compatible with existing and projected land uses and plans, if any:

Compliance with the County Comprehensive Plan and Zoning Ordinance.

m. Proposed measures to ensure the proposal is compatible with nearby agricultural and forest lands of long-term commercial significance, if any:

Not applicable, there are no nearby agricultural and forest lands of long-term commercial significance that will be affected by this project.

9. Housing

a. Approximately how many units would be provided, if any? Indicate whether high, middle, or low-income housing.

Not applicable, no housing is proposed.

b. Approximately how many units, if any, would be eliminated? Indicate whether high, middle, or low-income housing.

Not applicable.

c. Proposed measures to reduce or control housing impacts, if any:

Not applicable, none proposed.

10. Aesthetics

a. What is the tallest height of any proposed structure(s), not including antennas; what is the principal exterior building material(s) proposed?

No structures are proposed as part of this project.

b. What views in the immediate vicinity would be altered or obstructed?

No views will be altered or obstructed.

c. Proposed measures to reduce or control aesthetic impacts, if any:

None needed, none proposed.

11. Light and glare

a. What type of light or glare will the proposal produce? What time of day would it mainly occur?

No lighting is proposed by this project and no glare will be produced by this project.

b. Could light or glare from the finished project be a safety hazard or interfere with views?

No.

c. What existing offsite sources of light or glare may affect your proposal?

No off-site light or glare affects this proposal.

d. Proposed measures to reduce or control light and glare impacts, if any:

None needed, none proposed.

12. Recreation

a. What designated and informal recreational opportunities are in the immediate vicinity?

The project is in the general area of the Yakima Greenway and Sportsman's State Park. Both offer designated and informal outdoor recreational opportunities such as camping, fishing, walking, jogging and biking.

b. Would the proposed project displace any existing recreational uses? If so, describe.

No.

c. Proposed measures to reduce or control impacts on recreation, including recreation opportunities to be provided by the project or applicant, if any:

None needed, none proposed.

13. Historic and cultural preservation

a. Are there any buildings, structures, or sites, located on or near the site that are over 45 years old listed in or eligible for listing in national, state, or local preservation registers located on or near the site? If so, specifically describe.

None known by the applicant or property owner.

b. Are there any landmarks, features, or other evidence of Indian or historic use or occupation. This may include human burials or old cemeteries. Is there any material evidence, artifacts, or areas of cultural importance on or near the site? Please list any professional studies conducted at the site to identify such resources.

None known by the applicant or property owner.

c. Describe the methods used to assess the potential impacts to cultural and historic resources on or near the project site. Examples include consultation with tribes and the department of archeology and historic preservation, archaeological surveys, historic maps, GIS data, etc.

Not applicable, no cultural or historical resources are known to be on, or near, the project site.

d. Proposed measures to avoid, minimize, or compensate for loss, changes to, and disturbance to resources. Please include plans for the above and any permits that may be required.

Not applicable.

14. Transportation

a. Identify public streets and highways serving the site or affected geographic area, and describe proposed access to the existing street system. Show on site plans, if any.

The cemetery has direct access to Terrace Heights Drive.

b. Is the site or affected geographic area currently served by public transit? If so, generally describe. If not, what is the approximate distance to the nearest transit stop?

No. The nearest known site is in Yakima, WA about .5 miles west of the site.

c. How many additional parking spaces would the completed project or nonproject proposal have? How many would the project or proposal eliminate?

No new parking spaces are required for this project. None will be eliminated.

d. Will the proposal require any new or improvements to existing roads, streets, pedestrian, bicycle or state transportation facilities, not including driveways? If so, generally describe (indicate whether public or private).

No.

e. Will the project or proposal use (or occur in the immediate vicinity of) water, rail, or air transportation? If so, generally describe.

No.

f. How many vehicular trips per day would be generated by the completed project or proposal? If known, indicate when peak volumes would occur and what percentage of the volume would be trucks (such as commercial and non-passenger vehicles). What data or transportation models were used to make these estimates?

The completed project will not generate any vehicle trips per day.

g. Will the proposal interfere with, affect or be affected by the movement of agricultural and forest products on roads or streets in the area? If so, generally describe.

No.

h. Proposed measures to reduce or control transportation impacts, if any:

None proposed.

15. Public services

a. Would the project result in an increased need for public services (for example: Fire protection, police protection, public transit health care, schools, other)? If so, generally describe.

No increased need for public services should be expected.

b. Proposed measures to reduce or control direct impacts on public services, if any.

None needed, none proposed.

16. Utilities

a. Circle utilities currently available at the site: Electricity, natural gas, water, refuse service, telephone, sanitary sewer, septic system, other.

b. Describe the utilities that are proposed for the project, the utility providing the service, and the general construction activities on the site or in the immediate vicinity which might be needed.

No new utilities are proposed for the project, as no utilities are needed.

C. SIGNATURE

The above answers are true and complete to the best of my knowledge. I understand that the lead agency is relying on them to make its decision.

Signature: Lydia M. Webb

Date Submitted: 11/27/18



SEPA ENVIRONMENTAL REVIEW
(State Environmental Policy Act)

Form # PLN ENR 003-SC-A
Revised 4/1/10

Submission Checklist

Yakima County Public Services
128 North Second Street · Fourth Floor Courthouse · Yakima, Washington 98901
(509) 574-2300 · 1-800 572-7354 · FAX (509) 574-2301 · www.co.yakima.wa.us

(For staff use only)

APPLICANT: <u>HORDAN PLANNING SERVICES</u>	
PHONE: <u>509 249-1919</u>	
PROJECT DESCRIPTION (from application form):	
<u>LEVEL AND FULL VACANT PORTION OF TERRACE HEIGHTS MEMORIAL PARK</u>	

NOTE: Your application is not considered complete for processing until all applicable items have been submitted.

NOTE: It is recommended that construction plans not be submitted until after Planning permits are obtained since your permit may be denied or changes may be require to the construction plans, resulting in wasted or additional consultant and permit fee costs.

SEE INSTRUCTIONS ON PAGE 2

<p>1. Complete SEPA Application Form</p> <ul style="list-style-type: none"> * Did the property owner of record sign? <input checked="" type="radio"/> YES NO * Is there a contact phone number listed? <input checked="" type="radio"/> YES NO 	<p>List other related applications (zoning, subdivision, etc.):</p> <input type="checkbox"/>
<p>2. Completed Environmental Checklist</p> <ul style="list-style-type: none"> • Are all questions answered? <input checked="" type="radio"/> YES NO • Did the property owner of record sign? <input checked="" type="radio"/> YES NO 	<input type="checkbox"/>
<p>3. Complete written description of the project.</p>	<input type="checkbox"/>
<p>4. Site Plan</p> <ul style="list-style-type: none"> • Are all Site Plan Requirements met? <input checked="" type="radio"/> YES NO • Are all structures shown? (see air photos) <input checked="" type="radio"/> YES NO • Are all Critical Areas present shown? <input checked="" type="radio"/> YES <input checked="" type="radio"/> NO N/A • Have reproducible copies been provided? <input checked="" type="radio"/> YES NO 	<input type="checkbox"/>
<p>5. Appropriate fees paid</p>	<input type="checkbox"/>

By signing this form you are certifying that the above information is attached and accurate.

Landowner/Representative Signature: BHL Date: 11/27/18

NOTE: Representatives must be listed on the Application Form, with their signature.

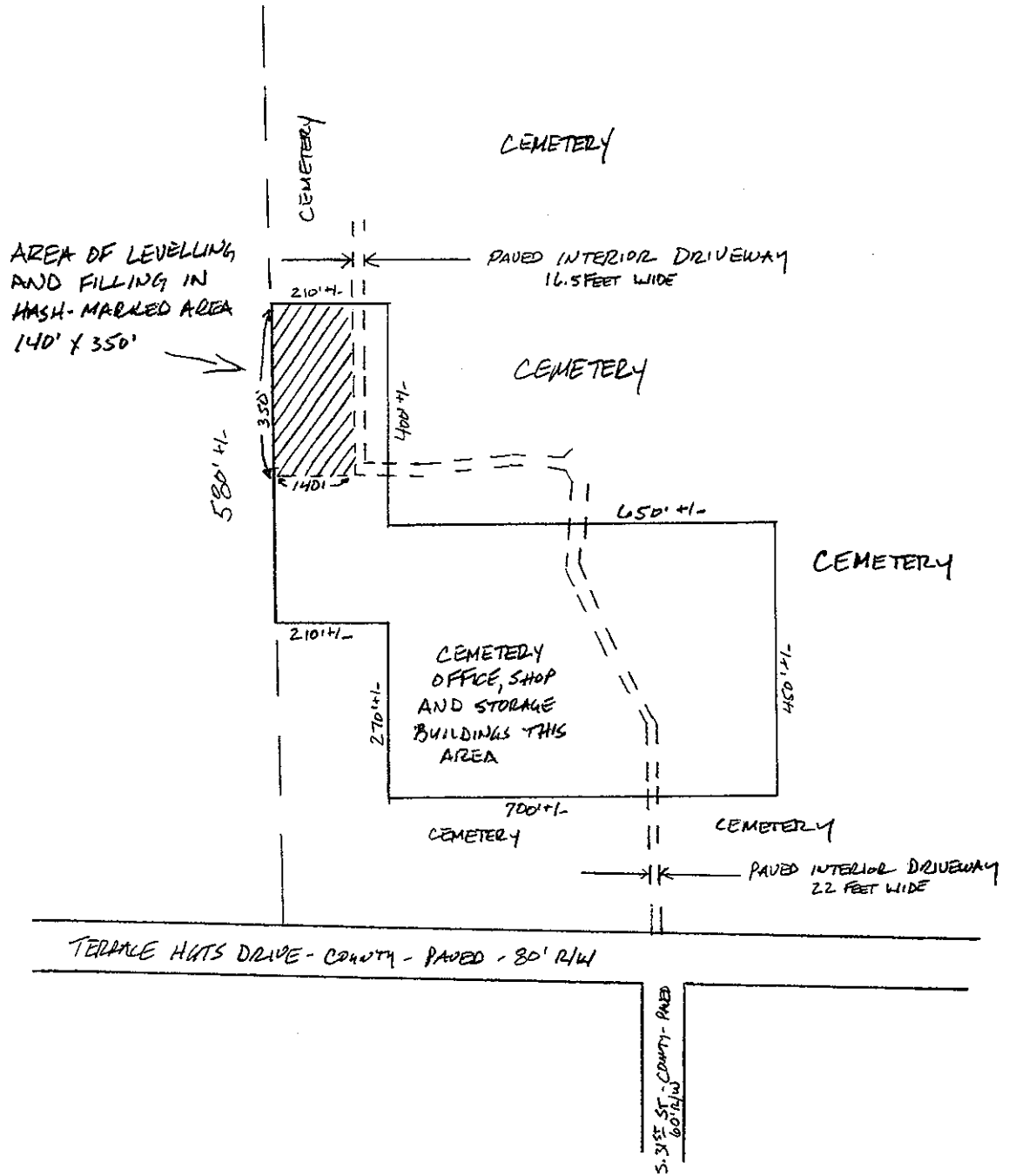

North ↑
 1" = 300'

TERACE HGTS. MEMORIAL PARK - OWNER
 HORDAN PLANNING SVCS - REP.
 410 N. 2ND ST. YAKIMA, WA 98901
 509-249-1919
 191316-34004
 11-27-18