



Public Services

128 North Second Street · Fourth Floor Courthouse · Yakima, Washington 98901
(509) 574-2300 · 1-800-572-7354 · FAX (509) 574-2301 · www.co.yakima.wa.us
VERNA REDFERN, P.E., Director

DATE: July 13, 2018
TO: Robert Rasmussen, et al and Interested Agencies
FROM: Yakima County Public Services Department: Planning Division
SUBJ: File No. SEP2018-00034/WET2018-00013: SEPA Review and Shoreline Exemption for Bank Repair
Notice of Environmental Review

DESCRIPTION OF PROPOSAL

Applicant: Robert Rasmussen et al.

Location: The project is located on the east side of Elk Valley Lane; approximately 1,300' southeast of the intersection of Elk Valley Road and Nile Valley Road; approximately 14 miles northwest of the City of Naches, WA. Parcel Identification Number(s): 151628-41409, 1511628-41408, 151628-41407, and 151628-41406 (please refer to attached "Site Location Map").

Application Submittal Date: June 22, 2018

Completeness Date: July 10, 2018

Proposal: The Yakima County Planning Division has received a SEPA Checklist for the maintenance and repair of rock groins and connective armoring along a segment of shoreline/bank of the Naches River, previously permitted in 2011 under project numbers WET2011-00031 and SEP2011-00037 in which buried rock groins were installed to provide protection of Elk Valley Road (a private access road) from the threat of continued lateral migration of the Naches River. Since 2011, the permitted rock groins have been eroded and/or destroyed resulting in a reduction of bank stabilization and protection. The applicant is proposing to restore the damaged groins to their previously permitted state by bringing in large angular rock to replace dislodged (and irretrievable) rock groins – the largest of the rock will be placed at the downstream face (southern bank) at an upstream angle to allow overtopping flows to be directed away from the bank. The applicant is also considering the placement of tree revetments within the project area for fish/wildlife habitat improvement with consultation from the Washington State Department of Fish & Wildlife. Disturbance to the bank edge shall be minimal since no excavation will be done aside from burying the anchoring for the root wads. Please also note that this SEPA Review is being considered concurrently with an application for a Shoreline Exemption Permit as this project is considered exempt from a Substantial Shoreline Development Permit (WAC 173-27-040(b)).

A land use application has been submitted near your property. To view the application materials and SEPA checklist online go to: www.yakimap.com/permits/ or you can view a copy of the materials at the Planning Division on the 4th floor of the Courthouse. This proposal is subject to environmental review. The Planning Division is lead agency for this proposal. Yakima County expects to issue a DNS for this proposal. The optional process authorized by WAC 197-11-355 is being used. This may be your only opportunity to comment on the environmental impacts of the proposal. The proposal may include mitigation measures under applicable codes, and the project review process may incorporate or require mitigation measures regardless of whether an EIS is prepared. After all comments have been received and considered, a final threshold determination will be made without an additional comment period. **Any person may provide written**

If you are a person with a disability who needs any accommodation in order to participate in this program, hearing or service, you may be entitled to receive certain assistance at no cost to you. Please contact the ADA Coordinator at Yakima County no later than five (5) working days prior to the date service is needed.
Yakima County ADA Coordinator, 128 N. 2nd Street, Room B27
Yakima, WA 98901, (509) 574-2210, 7-1-1 or 1-800-833-6384 (Washington Relay Services for deaf and hard of hearing)

comments on issues related to the proposal. All written comments must be received by 4:00 p.m., July 27, 2018. To be considered prior to making the final decision, all submitted comments must identify the name and physical or post office address of the sender. **Mail your comments on this project to Yakima County Planning Division, 128 N. 2nd St., 4th Floor Courthouse, Yakima, WA 98901. Be sure to reference the above case number in your correspondence.** Notice of the final decision will be sent to those who comment or may be obtained upon request. The final decision will contain specific appeal information and may be appealed within 14 days of the date of issuance. If you have questions, please call Nate Paris at (509) 574-2300.

Site Location Map (for reference purposes only):

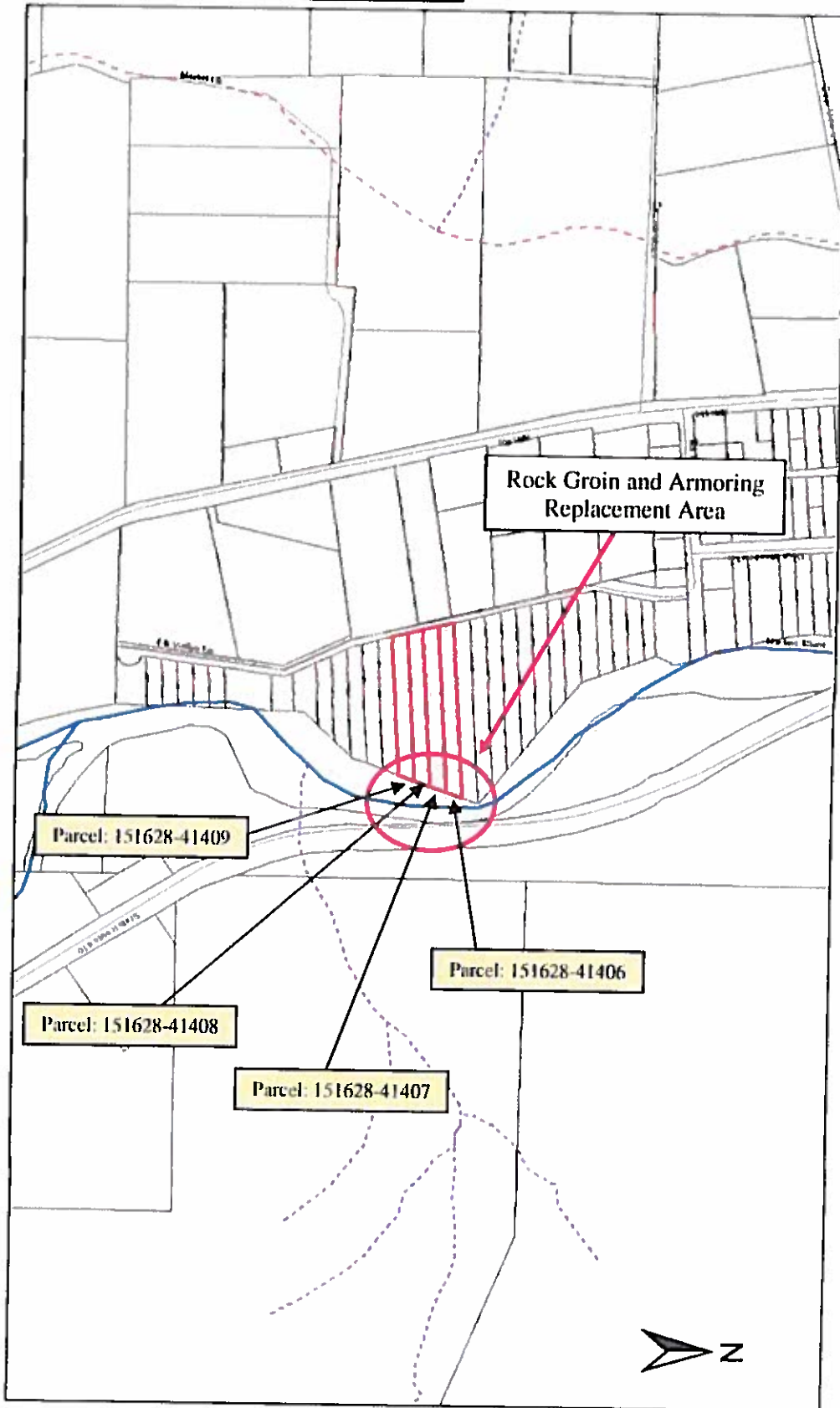

If you are a person with a disability who needs any accommodation in order to participate in this program, hearing or service, you may be entitled to receive certain assistance at no cost to you. Please contact the ADA Coordinator at Yakima County no later than five (5) working days prior to the date service is needed.

Yakima County ADA Coordinator, 128 N. 2nd Street, Room B27
Yakima, WA 98901, (509) 574-2210, 7-1-1 or 1-800-833-6384 (Washington Relay Services for deaf and hard of hearing)



SEPA ENVIRONMENTAL CHECKLIST

SUBMITTAL SUPPLEMENTAL

Form # PLN ENR 003-SS1-A
Revised 8/12/14

Yakima County Public Services
128 North Second Street · Fourth Floor Courthouse · Yakima, Washington 98901
(509) 574-2300 · 1-800-572-7354 · FAX (509) 574-2301 · www.co.yakima.wa.us

WAC 197-11-960 Environmental checklist.

Purpose of checklist:

The State Environmental Policy Act (SEPA), chapter 43.21C RCW, requires all governmental agencies to consider the environmental impacts of a proposal before making decisions. An environmental impact statement (EIS) must be prepared for all proposals with probable significant adverse impacts on the quality of the environment. The purpose of this checklist is to provide information to help you and the agency identify impacts from your proposal (and to reduce or avoid impacts from the proposal, if it can be done) and to help the agency decide whether an EIS is required.

<i>(For Staff Use Only)</i>	
DATE:	<u>6/22/18</u>
REVIEWED BY:	<u>B)G</u>
PROJECT #:	_____
CASE #:	<u>SEP18-034</u>
RELATED FILES:	<u>VET18-013</u>

Instructions for applicants:

This environmental checklist asks you to describe some basic information about your proposal. Governmental agencies use this checklist to determine whether the environmental impacts of your proposal are significant, requiring preparation of an EIS. Answer the questions briefly, with the most precise information known, or give the best description you can.

You must answer each question accurately and carefully, to the best of your knowledge. In most cases, you should be able to answer the questions from your own observations or project plans without the need to hire experts. If you really do not know the answer, or if a question does not apply to your proposal, write "do not know" or "does not apply." Complete answers to the questions now may avoid unnecessary delays later.

Some questions ask about governmental regulations, such as zoning, shoreline, and landmark designations. Answer these questions if you can. If you have problems, the governmental agencies can assist you.

The checklist questions apply to all parts of your proposal, even if you plan to do them over a period of time or on different parcels of land. Attach any additional information that will help describe your proposal or its environmental effects. The agency to which you submit this checklist may ask you to explain your answers or provide additional information reasonably related to determining if there may be significant adverse impact.

Use of checklist for nonproject proposals:

For nonproject proposals complete this checklist and the supplemental sheet for nonproject actions (Part D). The lead agency may exclude any question for the environmental elements (Part B) which they determine do not contribute meaningfully to the analysis of the proposal.

For nonproject actions, the references in the checklist to the words "project," "applicant," and "property or site" should be read as "proposal," "proposer," and "affected geographic area," respectively.

A. BACKGROUND

1. Name of proposed project, if applicable:

✓ Elk Valley Lane Protection Maintenance of previously permitted rock groins and armoring bank protection (HPA 124840-3 Dec 09, 2011 & WET011 31/SEP 11-037 Dec 19, 2011) on the Naches river bank at 370 Elk Valley Ln, Naches, WA

2. Name of applicant:

Robert Rasmussen

3. Address and phone number of applicant and contact person:

390 Elk Valley Ln. Naches WA 98037 509-658-1049

4. Date checklist prepared:

June 14, 2018

5. Agency requesting checklist:

Yakima County Public Services Planning Department

6. Proposed timing or schedule (including phasing, if applicable):

Work must be completed within WDFW time window.
August 1, thru August 31 2018

7. Do you have any plans for future additions, expansion, or further activity related to or connected with this proposal? If yes, explain.

Due to the chronic annual erosion damage to the project site, annual maintenance may be required.

8. List any environmental information you know about that has been prepared, or will be prepared, directly related to this proposal.

9. Do you know whether applications are pending for governmental approvals of other proposals directly affecting the property covered by your proposal? If yes, explain.

No

10. List any government approvals or permits that will be needed for your proposal, if known.

HPA

STAFF USE ONLY

11. Give brief, complete description of your proposal, including the proposed uses and the size of the project and site. There are several questions later in this checklist that ask you to describe certain aspects of your proposal. You do not need to repeat those answers on this page. (Lead agencies may modify this form to include additional specific information on project description.)

Three of Eight previously permitted and installed groins and connective armoring are to be restored. New large angular rock will be brought in to supplement dislodge rock that is not retrievable to restore the groins and armoring to their originally condition. The largest rock will be replaced at the downstream face of the damaged groins and oriented at an upstream angle so overtopping flows are directed away from the bank. The repaired height of damaged groins and armoring will be to that as defined in the original permitted HPA. Uprooted trees from the gravel bar may be placed in the restored groin/armoring to add protection and fish habitat as assisted by Eric Bartrand, WDFW Habitat Biologist. Bank edge riparian disturbance will be minimum as no excavation will be done except to bury anchoring for root wad trees.

12. Location of the proposal. Give sufficient information for a person to understand the precise location of your proposed project, including a street address, if any, and section, township, and range, if known. If a proposal would occur over a range of area, provide the range or boundaries of the site(s). Provide a legal description, site plan, vicinity map, and topographic map, if reasonably available. While you should submit any plans required by the agency, you are not required to duplicate maps or detailed plans submitted with any permit applications related to this checklist.

14 SEC-SE SEC-28 TOWNSHIP-18 RANGE-15E
48.84655N lat.
120.95139W long.
370 Elk Valley Lane, Naches WA

B. ENVIRONMENTAL ELEMENTS

1. Earth

a. General description of the site (circle one): Flat, rolling, hilly, steep slopes, mountainous, other.....

✓ Sloped, floodplain/floodway

b. What is the steepest slope on the site (approximate percent slope)?

One of the highest gradients on the Naches River

c. What general types of soils are found on the site (for example, clay, sand, gravel, peat, muck)? If you know the classification of agricultural soils, specify them and note any agricultural land of long-term commercial significance and whether the proposal results in removing any of these soils.

Silt, sand, river rock

d. Are there surface indications or history of unstable soils in the immediate vicinity? If so, describe.

No

e. Describe the purpose, type, total area, and approximate quantities and total affected area of any filling, excavation, and grading proposed. Indicate source of fill.

✓ Approximately 100 cubic yards of very large angular quarry rock was eroded from the 2011 permitted groins and armoring, seriously reducing protection from their permitted installed dimensions. Some of the displaced rock may be retrievable from the stream bed. Probably 100 cu yds of quarry rock must be brought in to restore the groins and armoring to their original permitted dimensions and bank protection effectiveness.

f. Could erosion occur as a result of clearing, construction, or use? If so, generally describe.

No

g. About what percent of the site will be covered with impervious surfaces after project construction (for example, asphalt or buildings)?

None 0%

h. Proposed measures to reduce or control erosion, or other impacts to the earth, if any:

Any disturbed surface will be revegetated with local native vegetation.

2. Air

a. What types of emissions to the air would result from the proposal during construction, operation, and maintenance when the project is completed? If any, generally describe and give approximate quantities if known.

None

b. Are there any offsite sources of emissions or odor that may affect your proposal? If so, generally describe.

No

c. Proposed measures to reduce or control emissions or other impacts to air, if any:

N/A

3. Water

a. Surface:

1) Is there any surface water body on or in the immediate vicinity of the site (including year-round and seasonal streams, saltwater, lakes, ponds, wetlands)? If yes, describe type and provide names. If appropriate, state what stream or river it flows into.

Naches River

2) Will the project require any work over, in, or adjacent to (within 200 feet) the described waters? If yes, please describe and attach available plans.

Work damage to existing woody vegetation will be avoided as much as possible and minimum sediment disruption retrieving displaced rock and replacement, there will be no excavation sediment discharge into the Naches channel. Rock retrieval and placement will be performed precisely with a thumb equipped excavator positioned on the bank above the ordinary high waterline. Prior to operation from the bank and retrieval of uprooted trees from the gravel bar the excavator will be clean of dirt and oil residue and travel in a manner to minimize impact.

3) Estimate the amount of fill and dredge material that would be placed in or removed from surface water or wetlands and indicate the area of the site that would be affected. Indicate the source of fill material.

None

4) Will the proposal require surface water withdrawals or diversions? Give general description, purpose, and approximate quantities if known.

No

5) Does the proposal lie within a 100-year flood plain? If so, note location on the site plan.

Yes, all parcels listed are in the flood plane/way.

STAFF USE ONLY

6) Does the proposal involve any discharges of waste materials to surface waters? If so, describe the type of waste and anticipated volume of discharge.

No

b. Ground:

1) Will groundwater be withdrawn from a well for drinking water or other purposes? If so, give a general description of the well, proposed uses and approximate quantities withdrawn from the well? Will water be discharged to groundwater? Give general description, purpose, and approximate quantities if known.

No

2) Describe waste material that will be discharged into the ground from septic tanks or other sources, if any (for example: Domestic sewage; industrial, containing the following chemicals...; agricultural; etc.). Describe the general size of the system, the number of such systems, the number of houses to be served (if applicable), or the number of animals or humans the system(s) are expected to serve.

None

c. Water runoff (including storm water):

1) Describe the source of runoff (including storm water) and method of collection and disposal, if any (include quantities, if known). Where will this water flow? Will this water flow into other waters? If so, describe.

None

2) Could waste materials enter ground or surface waters? If so, generally describe.

No

3) Does the proposal alter or otherwise affect drainage patterns in the vicinity of the site? If so, describe.

No

d. Proposed measures to reduce or control surface, ground, runoff water, and drainage pattern impacts, if any:

N/A

4. Plants

a. Check the types of vegetation found on the site:

Deciduous tree: Alder, maple, aspen, other

STAFF USE ONLY

- ✓ Evergreen tree: Fir, cedar, pine, other
- ✓ Shrubs
- ✓ Grass
- Pasture
- Crop or grain
- Orchards, vineyards or other permanent crops.
- Wet soil plants: Cattail, buttercup, bullrush, skunk cabbage, other
- Water plants: Water lily, eelgrass, milfoil, other
- Other types of vegetation

b. What kind and amount of vegetation will be removed or altered?

Only enough to install anchors for placement of uprooted trees.

c. List threatened and endangered species known to be on or near the site.

Bull Trout & Steelhead

d. Proposed landscaping, use of native plants, or other measures to preserve or enhance vegetation on the site, if any:

Any disturbed surface will be revegetated with local native vegetation.

e. List all noxious weeds and invasive species known to be on or near the site.

?

5. Animals

a. List any birds and other animals which have been observed on or near the site or are known to be on or near the site. Examples include:

Birds: Hawk, heron, eagle, songbirds, other:

Mammals: Deer, bear, elk, beaver, other:

Fish: Bass, salmon, trout, herring, shellfish, other:

b. List any threatened and endangered species known to be on or near the site.

see previous answer to this subject

c. Is the site part of a migration route? If so, explain.

Do not know

d. Proposed measures to preserve or enhance wildlife, if any:

e. List any invasive animal species known to be on or near the site.

?

6. Energy and natural resources

a. What kinds of energy (electric, natural gas, oil, wood stove, solar) will be used to meet the completed project's energy needs? Describe whether it will be used for heating, manufacturing, etc.

None

b. Would your project affect the potential use of solar energy by adjacent properties? If so, generally describe.

No

c. What kinds of energy conservation features are included in the plans of this proposal? List other proposed measures to reduce or control energy impacts, if any:

None

7. Environmental health

a. Are there any environmental health hazards, including exposure to toxic chemicals, risk of fire and explosion, spill, or hazardous waste that could occur as a result of this proposal? If so, describe.

No

1) Describe any known or possible contamination at the site from present or past uses.

None

2) Describe existing hazardous chemicals/conditions that might affect project development and design. This includes underground hazardous liquid and gas transmission pipelines located within the project area and in the vicinity.

None

3) Describe any toxic or hazardous chemicals that might be stored, used, or produced during the project's development or construction, or at any time during the operating life of the project.

None

4) Describe special emergency services that might be required.

None

5) Proposed measures to reduce or control environmental health hazards, if any:

None

STAFF USE ONLY

b. Noise

1) What types of noise exist in the area which may affect your project (for example: traffic, equipment, operation, other)?

None

2) What types and levels of noise would be created by or associated with the project on a short-term or a long-term basis (for example: traffic, construction, operation, other)? Indicate what hours noise would come from the site.

Minimum track-hoe noise

3) Proposed measures to reduce or control noise impacts, if any:

None

8. Land and shoreline use

a. What is the current use of the site and adjacent properties? Will the proposal affect current land uses on nearby or adjacent properties? If so, describe.

Personal residence

b. Has the project site been used as working farmlands or working forest lands? If so, describe. How much agricultural or forest land of long-term commercial significance will be converted to other uses as a result of the proposal, if any? If resource lands have not been designated, how many acres in farmland or forest land tax status will be converted to nonfarm or nonforest use?

No

1) Will the proposal affect or be affected by surrounding working farm or forest land normal business operations, such as oversize equipment access, the application of pesticides, tilling, and harvesting? If so, how:

No

c. Describe any structures on the site.

d. Will any structures be demolished? If so, what?

No

e. What is the current zoning classification of the site?

Rural

f. What is the current comprehensive plan designation of the site?

?

g. If applicable, what is the current shoreline master program designation of the site?

?

h. Has any part of the site been classified critical area by the city or county? If so, specify.

I think so

i. Approximately how many people would reside or work in the completed project?

0

j. Approximately how many people would the completed project displace?

0

k. Proposed measures to avoid or reduce displacement impacts, if any:

N/A

l. Proposed measures to ensure the proposal is compatible with existing and projected land uses and plans, if any:

None

m. Proposed measures to ensure the proposal is compatible with nearby agricultural and forest lands of long-term commercial significance, if any:

None

9. Housing

a. Approximately how many units would be provided, if any? Indicate whether high, middle, or low-income housing.

0

b. Approximately how many units, if any, would be eliminated? Indicate whether high, middle, or low-income housing.

0

c. Proposed measures to reduce or control housing impacts, if any:

0

10. Aesthetics

a. What is the tallest height of any proposed structure(s), not including antennas; what is the principal exterior building material(s) proposed?

N/A

b. What views in the immediate vicinity would be altered or obstructed?

None

STAFF USE ONLY

c. Proposed measures to reduce or control aesthetic impacts, if any:

None

11. Light and glare

a. What type of light or glare will the proposal produce? What time of day would it mainly occur?

0

b. Could light or glare from the finished project be a safety hazard or interfere with views?

No

c. What existing offsite sources of light or glare may affect your proposal?

None

d. Proposed measures to reduce or control light and glare impacts, if any:

None

12. Recreation

a. What designated and informal recreational opportunities are in the immediate vicinity?

Fishing

b. Would the proposed project displace any existing recreational uses? If so, describe.

No

c. Proposed measures to reduce or control impacts on recreation, including recreation opportunities to be provided by the project or applicant, if any:

None

13. Historic and cultural preservation

a. Are there any buildings, structures, or sites, located on or near the site that are over 45 years old listed in or eligible for listing in national, state, or local preservation registers located on or near the site? If so, specifically describe.

No

b. Are there any landmarks, features, or other evidence of Indian or historic use or occupation. This may include human burials or old cemeteries. Is there any material evidence, artifacts, or areas of cultural importance on or near the site? Please list any professional studies conducted at the site to identify such resources.

None

c. Describe the methods used to assess the potential impacts to cultural and historic resources on or near the project site. Examples include consultation with tribes and the

STAFF USE ONLY

department of archeology and historic preservation, archaeological surveys, historic maps, GIS data, etc.

None

d. Proposed measures to avoid, minimize, or compensate for loss, changes to, and disturbance to resources. Please include plans for the above and any permits that may be required.

None

14. Transportation

a. Identify public streets and highways serving the site or affected geographic area, and describe proposed access to the existing street system. Show on site plans, if any.

Elk Valley Ln is not a public street.

b. Is the site or affected geographic area currently served by public transit? If so, generally describe. If not, what is the approximate distance to the nearest transit stop?

No

c. How many additional parking spaces would the completed project or nonproject proposal have? How many would the project or proposal eliminate?

No

d. Will the proposal require any new or improvements to existing roads, streets, pedestrian, bicycle or state transportation facilities, not including driveways? If so, generally describe (indicate whether public or private).

No

e. Will the project or proposal use (or occur in the immediate vicinity of) water, rail, or air transportation? If so, generally describe.

No

f. How many vehicular trips per day would be generated by the completed project or proposal? If known, indicate when peak volumes would occur and what percentage of the volume would be trucks (such as commercial and nonpassenger vehicles). What data or transportation models were used to make these estimates?

0

g. Will the proposal interfere with, affect or be affected by the movement of agricultural and forest products on roads or streets in the area? If so, generally describe.

No

h. Proposed measures to reduce or control transportation impacts, if any:

None

STAFF USE ONLY

15. Public services

a. Would the project result in an increased need for public services (for example: Fire protection, police protection, public transit health care, schools, other)? If so, generally describe.

No

b. Proposed measures to reduce or control direct impacts on public services, if any.

None

16. Utilities

a. Circle utilities currently available at the site: Electricity, natural gas, water, refuse service, telephone, sanitary sewer, septic system, other.

N/A

b. Describe the utilities that are proposed for the project, the utility providing the service, and the general construction activities on the site or in the immediate vicinity which might be needed.

N/A

C. SIGNATURE

The above answers are true and complete to the best of my knowledge. I understand that the lead agency is relying on them to make its decision.

Signature: _____

R. Rasmussen



Date Submitted: _____

6/22/2018

STAFF USE ONLY

D. SUPPLEMENTAL SHEET FOR NONPROJECT ACTIONS

(do not use this sheet for project actions)

Because these questions are very general, it may be helpful to read them in conjunction with the list of the elements of the environment.

When answering these questions, be aware of the extent the proposal, or the types of activities likely to result from the proposal, would affect the item at a greater intensity or at a faster rate than if the proposal were not implemented. Respond briefly and in general terms.

1. How would the proposal be likely to increase discharge to water; emissions to air; production, storage, or release of toxic or hazardous substances, or production of noise?

It will not.

Proposed measures to avoid or reduce such increases are:

N/A

2. How would the proposal be likely to affect plants, animals, fish, or marine life?

Timing of the project will be established by WDFW to mitigate this issue.

Proposed measures to protect or conserve plants, animals, fish, or marine life are:

HPA issued by WDFW will define these criteria and will be followed.

3. How would the proposal be likely to deplete energy or natural resources?

It will not.

Proposed measures to protect or conserve energy and natural resources are:

See 2. Above

4. How would the proposal be likely to use or affect environmentally sensitive areas or areas designated (or eligible or under study) for governmental protection; such as parks, wilderness, wild and scenic rivers, threatened or endangered species habitat, historic or cultural sites, wetlands, flood plains, or prime farmlands?

?

Proposed measures to protect such resources or to avoid or reduce impacts are:

See 2. above

5. How would the proposal be likely to affect land and shoreline use, including whether it would allow or encourage land or shoreline uses incompatible with existing plans?

It will not.

Proposed measures to avoid or reduce shoreline and land use impacts are:

N/A

6. How would the proposal be likely to increase demands on transportation or public services and utilities?

N/A

Proposed measures to reduce or respond to such demand(s) are:

N/A

7. Identify, if possible, whether the proposal may conflict with local, state, or federal laws or requirements for the protection of the environment.

?

After 2011 permitted groin installation

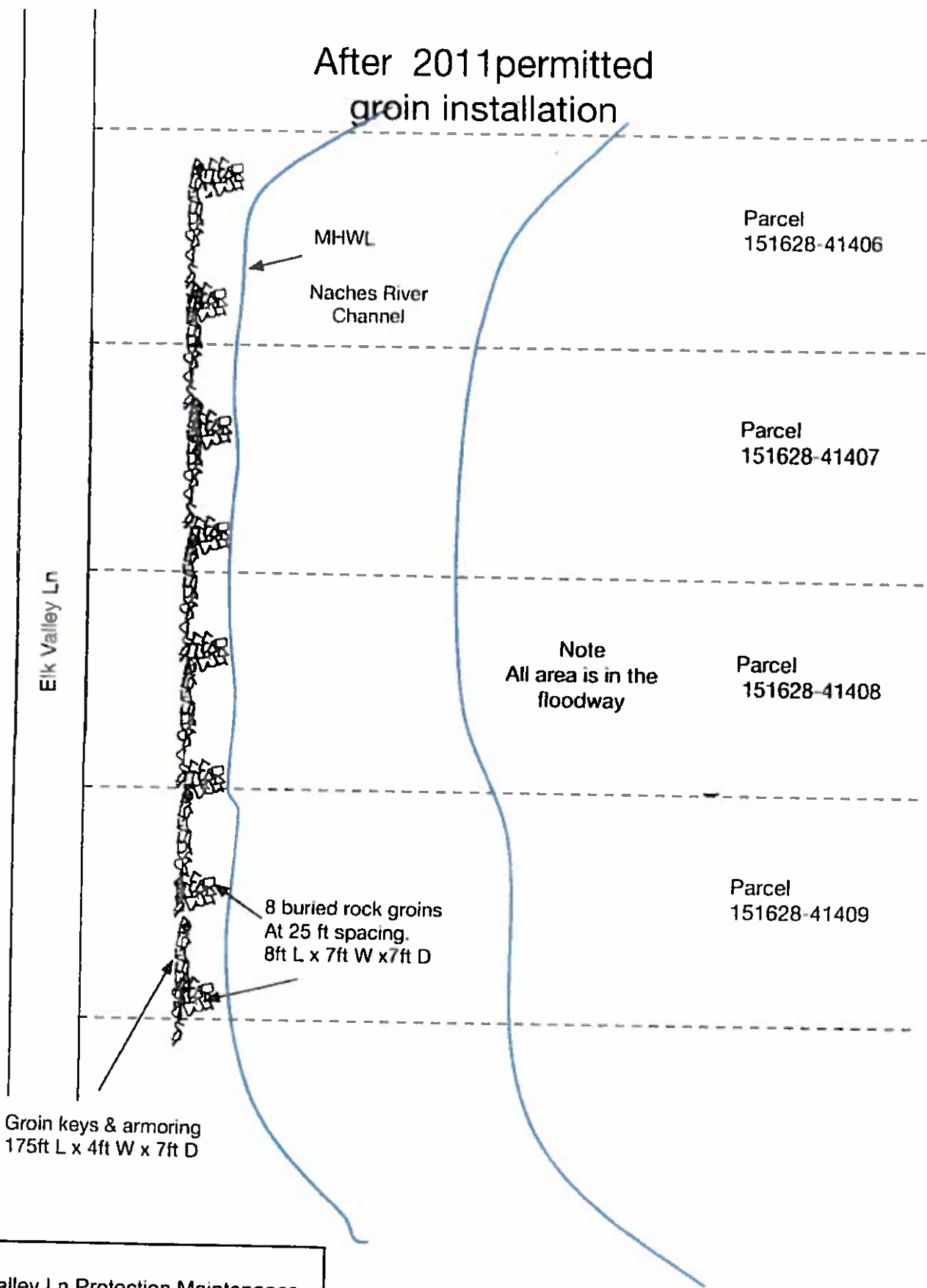

Groin keys & armoring
175ft L x 4ft W x 7ft D

8 buried rock groins
At 25 ft spacing.
8ft L x 7ft W x 7ft D

Note
All area is in the
floodway

Parcel
151628-41406

Parcel
151628-41407

Parcel
151628-41408

Parcel
151628-41409

Elk Valley Ln

Elk Valley Ln Protection Maintenance
370 Elk Valley Ln, Naches Wa, 98937
509-658-1049
Drawing not to scale

Site Plan View 1 of 3

After 2017 & 2018 high water bank erosion & loss of protection

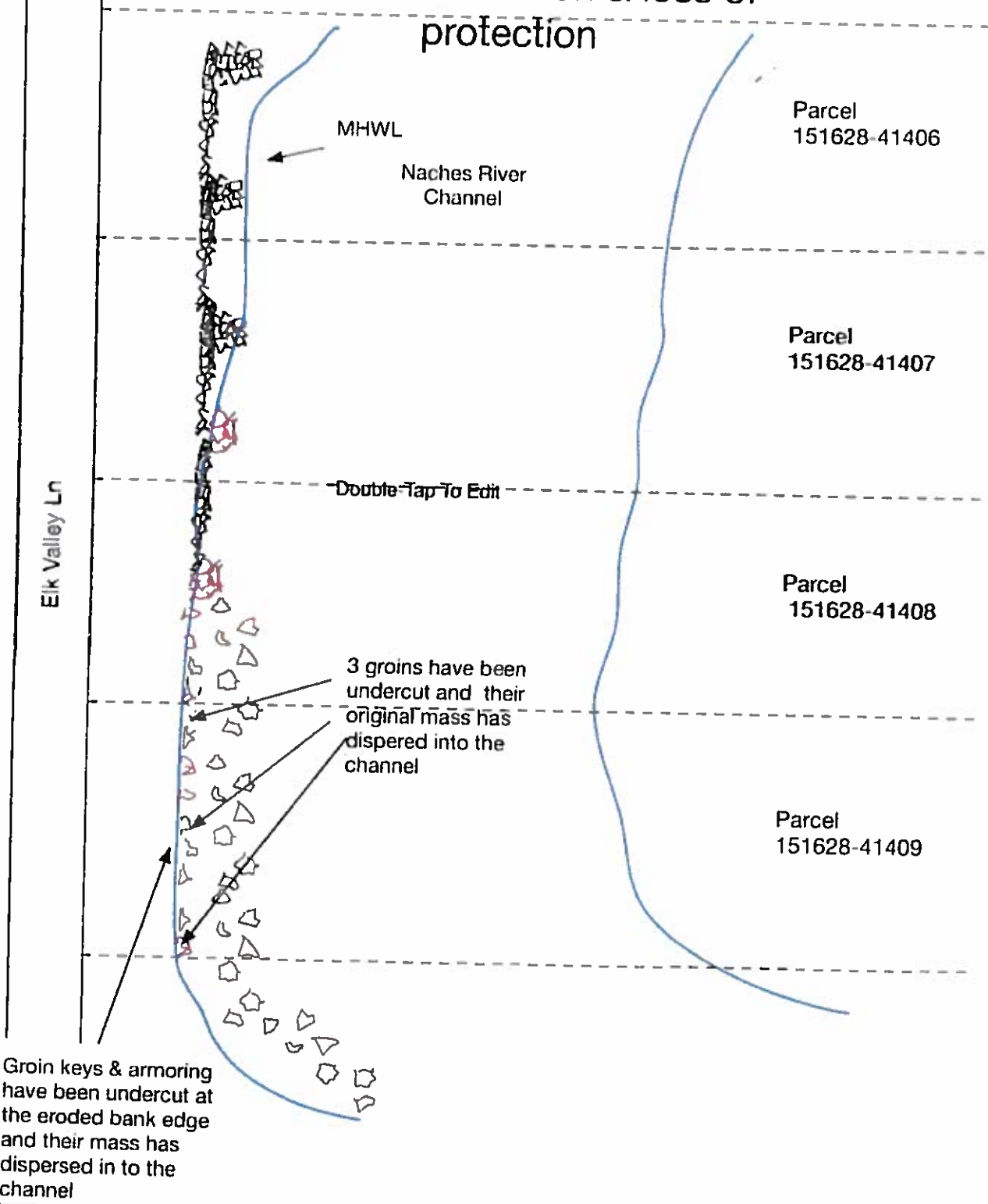

Groin keys & armorings have been undercut at the eroded bank edge and their mass has dispersed in to the channel

Elk Valley Ln Protection Maintenance
370 Elk Valley Ln, Naches Wa, 98937
509-658-1049
Drawing not to scale

After 2018 Groin & Armoring Reconstruction

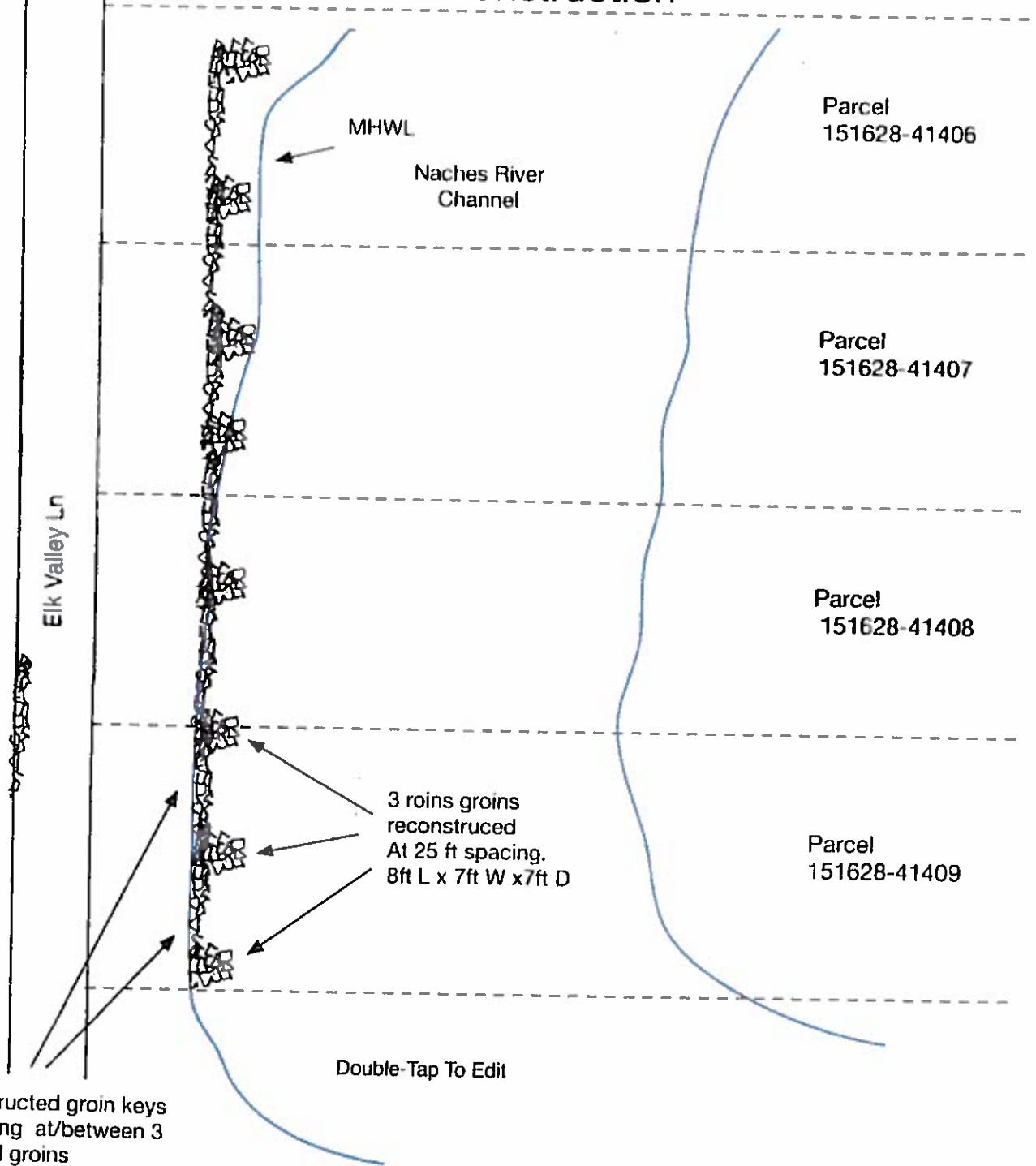

Reconstructed groin keys
& armoring at/between 3
restored groins

Elk Valley Ln Protection Maintenance
370 Elk Valley Ln, Naches Wa, 98937
509-658-1049
Drawing not to scale

After 2011 groin installation

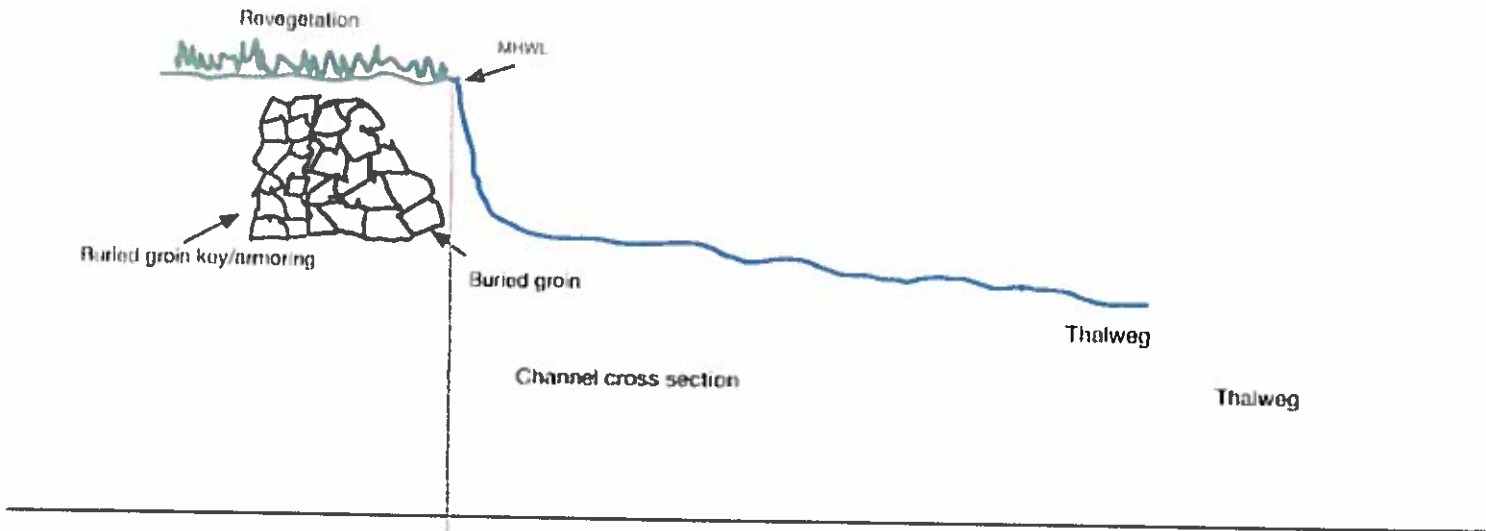

After 2017 & 2018 high water bank erosion & loss of protection

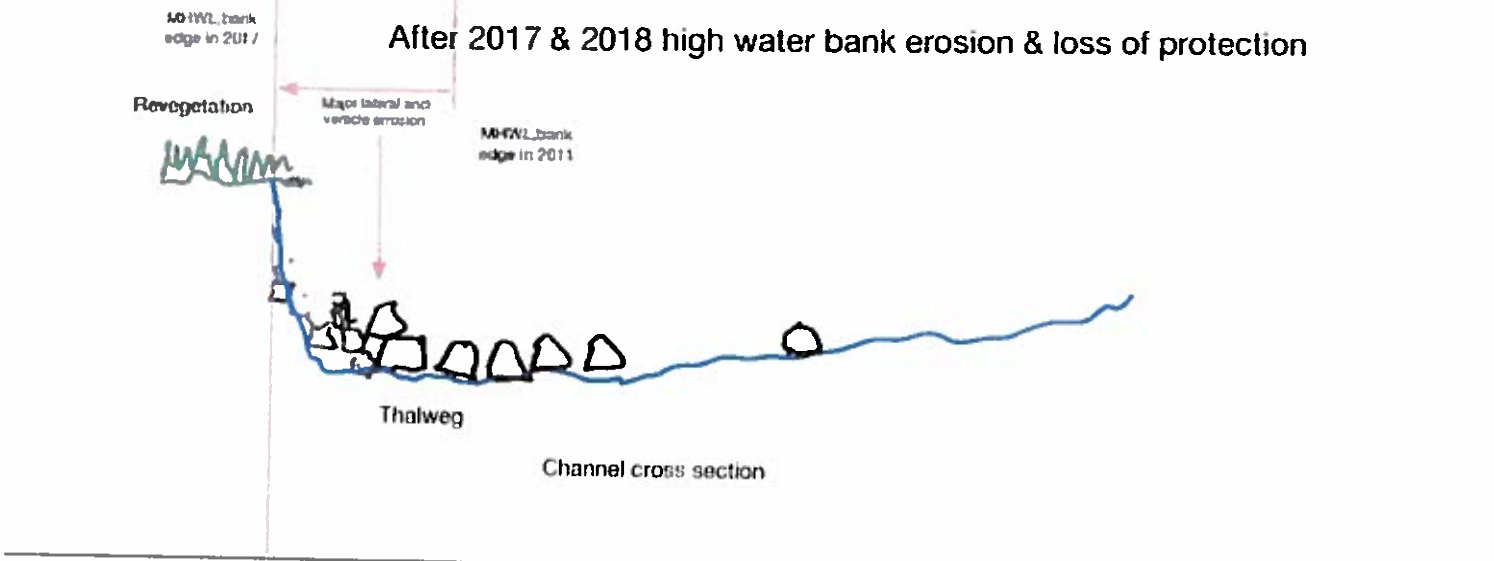

After 2018 bank protection reconstruction

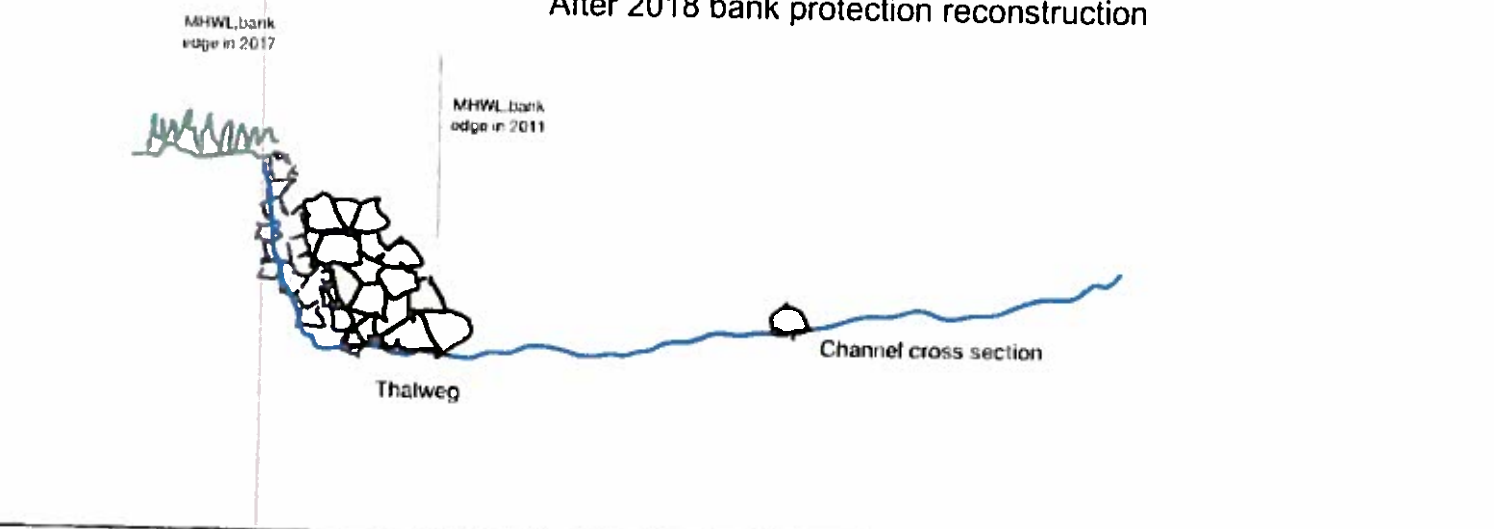

Elk Valley Ln Protection Maintenance
370 Elk Valley Ln, Naches Wa, 98937
509-658-1049
Drawing not to scale

SITE PLAN
CROSS SECTION
VIEWS

370 Elk Valley Ln Protection Maintenance Repair site photos

